

PRM Architects + Town Planners – Profile.

PRM Architects started on the south coasts in Vincentia-1980, when Patrick moved from Sydney as a graduate architect. Then our focus was Passive Solar residential design. Now PRM have designed 38 individual homes in Vincentia alone and well over 850 homes, renovations and apartments across Shoalhaven, Illawarra, Sydney and Gosford region.

PRM has diversified into many new areas of commercial architecture and Town Planning. In particular, multi-unit housing, apartment accommodation, Mixed-Use commercial + Medical projects.

PRM Design Principles.

Our message and ambition as architects and community planners, is to provide clients the highest *quality of life* through *innovative and individual design solutions*, *affordably* using ESD Principles.

Each new client and site is an occasion to create a unique design solution. We strive in each design to create a cost effective, individually designed project, which focuses on quality of lifestyle. Each of our projects includes:

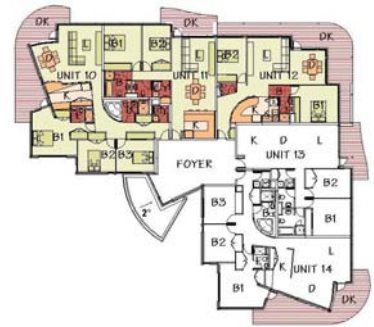

Apartments-*The Admiralty*-Jervis Bay

- ☑ **Passive Solar**-energy efficient– 5 Star rating. Or ‘**Energy Smart homes**’ PRM are Accredited ABSA assessors. We use NatHers computer simulation software, to help design all our projects with **5 star** energy efficiency and PRM are **Regional BASIX** accredited.
- ☑ **Low maintenance** construction materials and detailing. Most of our projects are in severe marine environments, PRM specify materials and finishes to minimise maintenance costs.
- ☑ **Innovative** & exciting spatial interiors which merge the inside with the outside. Most of our clients move away from large cities for lifestyle reasons, we aim to bring the outdoors in.
- ☑ **Affordable**. A simple term, but one PRM take very seriously. We are the only architects on the South Coast who offer **Project Construction Management**. PRM feel it is the only way today to peg rising building costs and dropping construction standards.

PRM & 3D CAD creating the Virtual Building

Whilst computers may ultimately inherit the earth, PRM made an early commitment to documenting and develop the designs of our buildings on CAD. The benefits for our clients are considerable. **Our system is 3D**. Our clients can sit with us; look at any view, inside or out, of a real time model at an early stage well before construction begins on site. This enables you to see now, rather than wait till to understand what the project really looks like.

Virtual Building means you don’t have to worry about whether you are ‘good at reading plans’ we can look at a real-time model of your building as it will actually be!

PRM Services & Fees For 25 years PRM have developed our services to suit the specific needs of our clients, the aim has been to balance the appropriate amount of effort for a reasonable fee.



Solberg Residence PRM



Mixed Use Development-Wollongong

Vincentia 444 16 444

Gerringong 42340-444

Mail: P.O. Box 323 Gerringong NSW 2534 Fax 42 340 341 Email: patrick@prm-architects.com.au A.C.N 003 464 480

Director: Patrick Mahedy, Architect, Bachelor of Architecture UNSW, Town Planner, Master of Town Planning UTS
Patrick Mahedy ARB No 4770 is the **Nominated Architect** for Patrick R. Mahedy P/L trading as **PRM Architects + Town Planners**
RAIA -Royal Australian Institute of Architects **AIUS** Australian Institute of Urban Studies **PIA**- Planning Institute of Australia

“Innovation in architecture and sustainable urban environment by design excellence”