

# SOLBERG RESIDENCE

## Jervis Bay

Architects Statement - Over \$300,000 + Energy Efficient

Craig and Kylie had lived in other homes and realised something was missing – Spatial Planning.

During our discussions, we focused on designing for their Lifestyle, spatially zoning the family living areas, maximising the opportunities of the steeply sloping site, connecting with the outdoors + a spacious cantilever balcony. Also Passive Solar Design – 5 Star principles, ensuring privacy from neighbours.

The design by PRM has met all their expectations and created a unique building which is adaptable to their family lifestyle and connected with the Jervis Bay environment

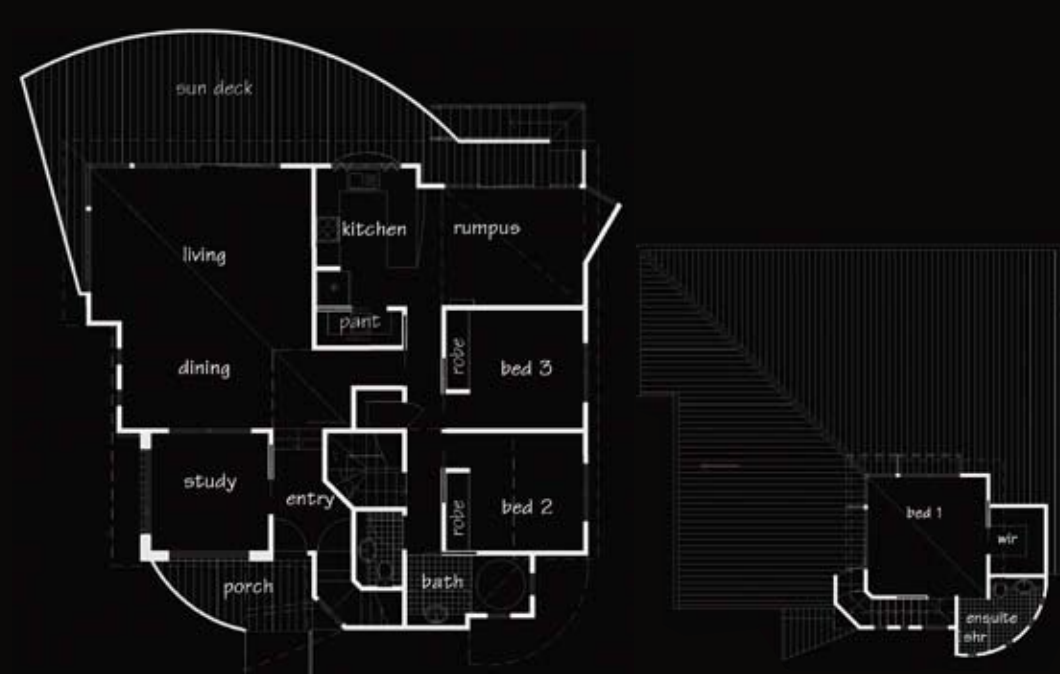
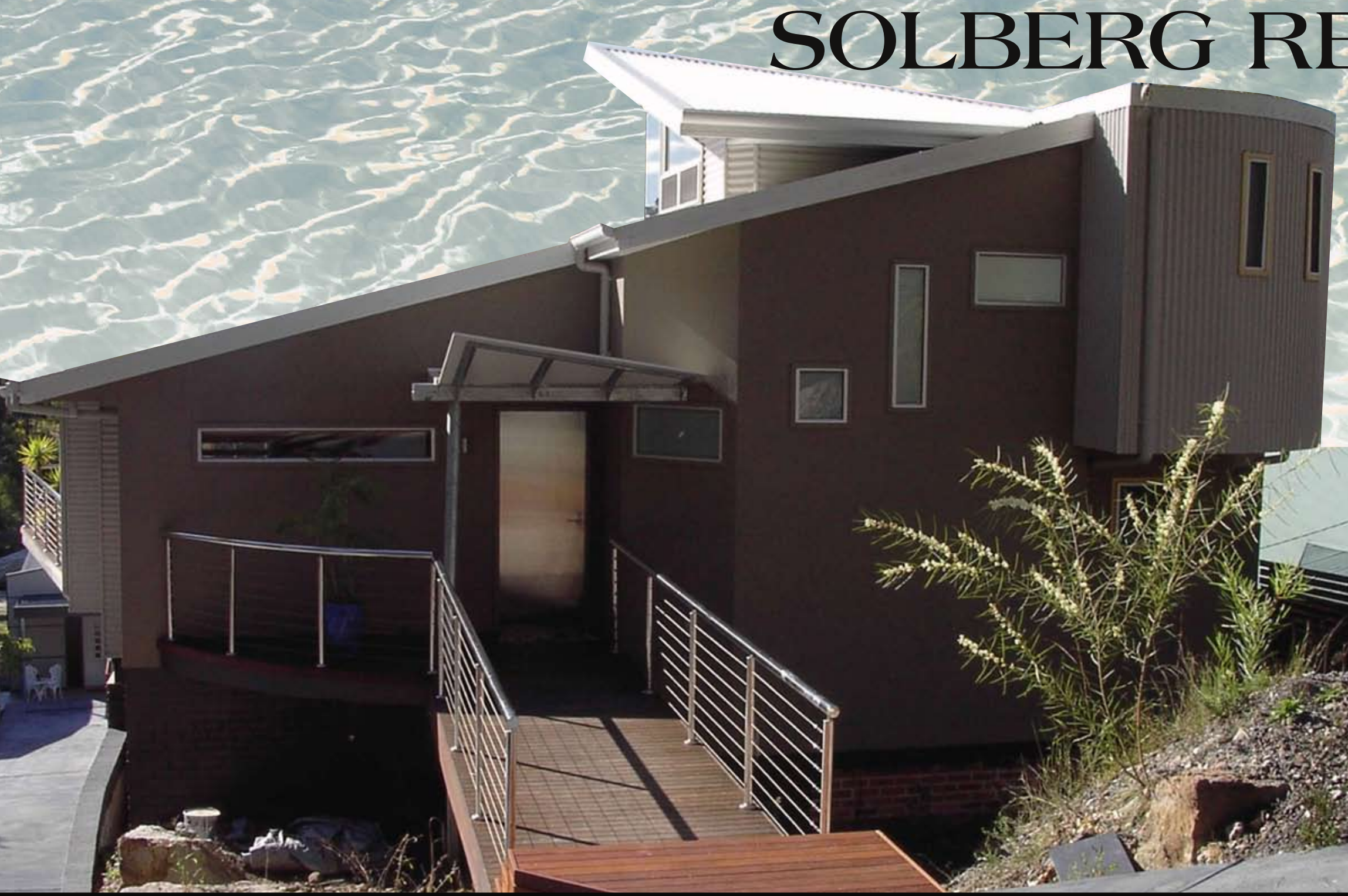

Ground Floor Plan

First Floor



Section



West Elevation



Shoalhaven  
2006  
BUILDING  
DESIGN AWARDS

PRM Architects  
Town Planners

Vincentia 444 16 444

Gerringong 42 340 444

